

Portable Coin Counter CS-20TRAD Integration Guide

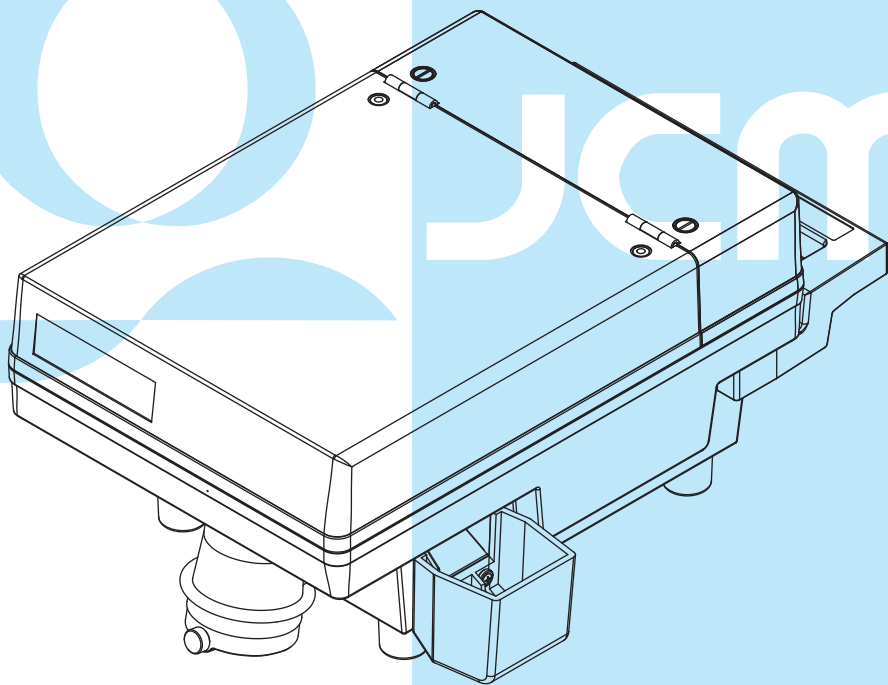

Table of Contents

1. Precautions	3
1-1. Warning	3
1-2. Caution	3
2. Package Contents	4
3. FCC Acknowledgment	4
4. CE Marking	5
5. RoHS Compliance	5
6. Names of Parts	6
7. Product Specifications	7
7-1. General Specifications	7
7-2. Electrical Specifications	7
7-3. Environmental Specifications	7
7-4. Structural Specifications	7
8. External Dimensions/Installation Space	8
8-1. External Dimensions	8
8-2. Installation Space	8
9. Installing/Removing Reject Cup (Chute)	9
10. Operating Procedure	9
10-1. Adjustment of coin thickness/diameter	9
10-2. Normal Mode	11
10-3. Batch Mode	12
11. Coin JAM	13
12. Error Detection	14
13. Cleaning	14
14. Replacing Fuse	15
15. Product Support	16

1. Precautions

Thank you for purchasing JCM's Portable Coin Counter CS-20TRAD unit. Please be sure to read the following and any related documents thoroughly to understand the correct operation and features of this unit.

1-1. Warning

- The CS-20TRAD should not be used in the following locations.
 - Locations that slope or are not level
 - Locations in direct sunlight
 - Dusty locations
 - Wet locations
 - Locations with vibrations
 - Near hazards
- Do not deliberately insert metallic or flammable objects in the unit.
- Inserting the power source plug with wet hands can result in electrical shock. Please be careful.
- Do not share the same outlet with other equipment.
- Please do not pull on the electric cord or forcibly bend it.
- If a foreign object (metallic material or liquid, etc.) is inserted, turn off the power and disconnect the electric plug.
- Please always ground the CS-20TRAD to prevent electrical shock or catching fire.
- Please never disassemble or adapt the CS-20TRAD.
- Please disconnect the electrical power before changing a fuse. Only replace with a fuse with the same model name and the same rating to continue to protect against the danger of fire.

1-2. Caution

- The CS-20TRAD is not a device to confirm the selection of mixed coins.
- The CS-20TRAD should not be used in high temperature humid locations.
- Please unplug the CS-20TRAD before moving it.
- Please remove any damaged coins or dust before counting coins.
- Please confirm that there are no coins that have not been counted left in the reject cup after the counting has completed.
- Please regularly clean the CS-20TRAD to maintain device operation.
- Please confirm that the unit power is turned OFF before cleaning and that the Power plug has been disconnected.
- Please use a dry cloth to clean the exterior of the CS-20TRAD.
- Please do not use volatile chemicals such as benzene or thinner, etc.
- Please use a commercial cleaner if it is very dirty.
- Please gently wipe the coin path and the numeric display screen gently with a soft cloth.

2. Package Contents

The following items are contained within the CS-20TRAD packaging.

■ **CS-20TRAD unit**

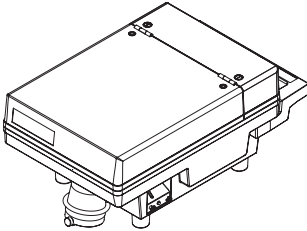

■ **Integration Guide** <This guide>

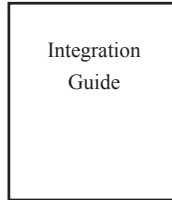

■ **Reject Cup**



■ **Reject Chute**



■ **Power Cord**

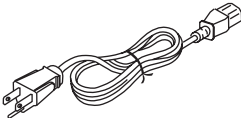

■ **Spare Fuse**
(Attached to CS-20TRAD unit)



- **This unit has been carefully packed, with special attention taken in regard to quality. However if you happen to find anything damaged or missing, please contact your local distributor immediately.**

3. FCC Acknowledgment

The CS-20TRAD unit has been tested and found to comply with the limits for a Class A digital device, pursuant to part 15 of the FCC Rules. These limits are designed to provide reasonable protection against harmful interference when the CS-20TRAD unit is operated in a commercial environment. The CS-20TRAD unit generates, uses, and radiates radio frequency energy and, if not installed and used in accordance with the instruction manual, may cause harmful interference to radio communications. Operation of the CS-20TRAD unit in a residential area likely to cause harmful interference in which case the user will be required to correct the interference at his own expense.

4. CE Marking

DECLARATION OF CONFORMITY

MANUFACTURER

Name : JAPAN CASH MACHINE CO., LTD.
Address : 3-15, 2-chome, Nishiwaki, Hirano-ku, Osaka, 547-0035 Japan
Phone : +81-6-6703-8405
Fax : +81-6-6704-7843

DETAILS OF PRODUCT : Coin Counter

MODEL TYPES : CS-20TRAD

THIS PRODUCT CONFORMS TO THE ESSENTIAL REQUIEIMENTS OF :

Electromagnetic Compatibility Directive 89/336/EEC
Amended by 92/31/EEC, 93/68/EEC
Low Voltage Directive 73/23/EEC
Amended by 93/68/EEC

and is supported by the following applicable standards

EN61000-6-1 : 2001,	EN55024 : 1998+A1 : 2001+A2 : 2003
EN61000-4-2 : 1995+A1 : 1998+A2 : 2001,	EN61000-4-3 : 2002+A1 : 2002
EN61000-4-4 : 1995+A1 : 2001+A2 : 2001	EN61000-4-5 : 1995+A1 : 2001
EN61000-4-6 : 1996+A1 : 2001,	EN61000-4-8 : 1993+A1 : 2001
EN61000-4-11 : 1994+A1 : 2001,	EN61000-6-3 : 2001
EN55022 : 2006 ClassB,	EN61000-3-2 : 2000;A2 : 2005
EN61000-3-3 : 1995+A1 : 2001+A : 2005,	EN60950-1 : 2001+A11 : 2004

Authorized signatory on behalf of the responsible person

Name/Signature: Hideji Naruo / *Hideji Naruo*
Date : September 12, 2007
Position : Director, quality management headquarters

Germany Office

Address : Mündelheimer Weg 60, 40472 Düsseldorf, Germany
Phone : +49-211-530645-0
Fax : +49-211-530645-65

5. RoHS Compliance

The CS-20TRAD unit is a RoHS Compliant products. The following six kind of hazardous substances restricted by RoHS are NOT contained in the unit.

Restricted Hazardous Substances

- Plumbum
- Mercury
- Cadmium
- Chromium Hexavalent
- PBB
- PBDE



6. Names of Parts

The name of parts for the CS-20TRAD unit are as follows.

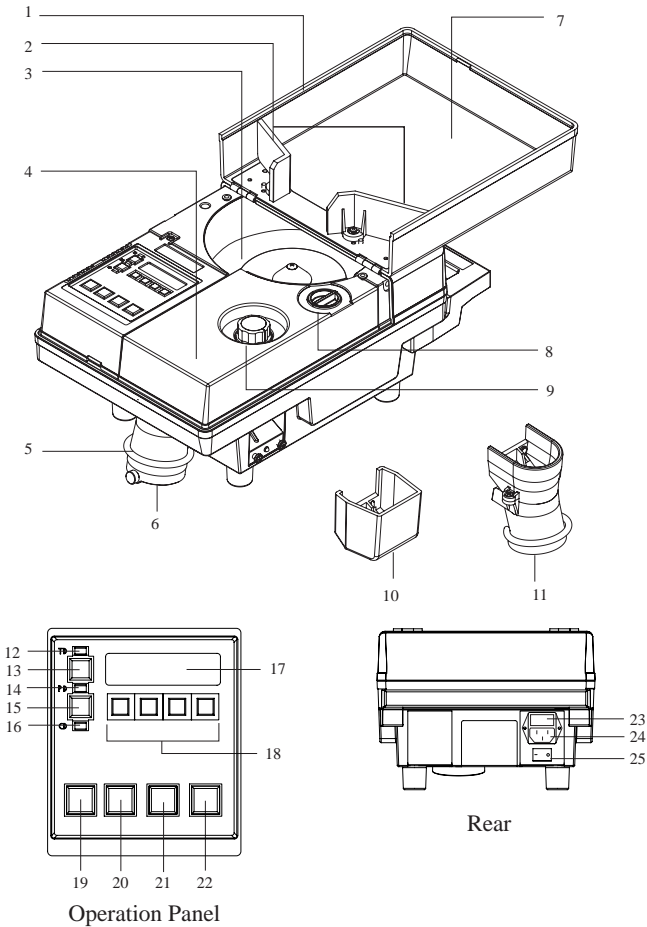

- | | | |
|----------------------------------|-----------------------------------|---------------------------|
| 1. Unit Cover | 2. Coin Guides | 3. Turn Table |
| 4. Transport Unit Cover | 5. Corn Ring | 6. Coin Outlet |
| 7. Coin Tray | 8. Coin Thickness Adjustment Dial | 11. Reject Chute |
| 9. Coin Deameter Adjustment Dial | 10. Reject Cup | 12. Normal Mode Lamp (TD) |
| 12. Normal Mode Lamp (TD) | 13. Normal Mode Key (∞) | 14. Batch Mode Lamp (PD) |
| 15. Batch Mode Key (S/B) | 16. Batch Count Lamp (CD) | 17. Display Screen |
| 18. Preset Keys | 19. Start Key (START) | 20. Stop Key (STOP) |
| 21. Reverse Key (REV) | 22. Clear Key (CLR) | 23. Fuse Holder |
| 24. Power Connector | 25. Power Switch | |

7. Product Specifications

7-1. General Specifications

Acceptable Coin	Diameter: 14mm to 34mm, Thickness: 0.8mm to 3.2mm
Rejection Condition	0.6mm smaller than the set diameter, or less
Operation Speed	1,500 coins/min (ϕ 22, t1.5 coins) \pm 10%
Coin Tray Capacity	Approx. 1,700 coins (ϕ 22, t1.5 coin)
Turntable Capacity	Approx. 350 coins (ϕ 22, t1.5 coin)
Reject Cup Capacity	Approx. 15 coins (ϕ 22, t1.5 coin)
Coin Width Adjustable Range *1	14mm to 34mm (Adjustment Pitch: 0.27mm/pitch)
Coin Thickness Adjustable Range *1	0.8mm to 3.2mm (Adjustment Pitch: 0.2mm/pitch)

*1 Some coins may be difficult to count with CS-20TRAD unit. Please contact your local distributor to discuss.

7-2. Electrical Specifications

Power Voltage	AC115V \pm 10% (60Hz)/AC220V, AC240 \pm 5% (50Hz)
Frequency	50Hz/60Hz \pm 5%
Consumption Current	Idling: 0.068A Operation: 0.720A
Power Consumption	Idling: 4.5W Operation: 54.0W
Leak Current	Less than 1mA

7-3. Environmental Specifications

Use Environment	Indoor Use Only
Ambient Temperature	Operating:+5 to +40°C Storing:-5 to +50°C
Ambient Humidity	Operating:40 ~ 80%Rh (Non condensation) Storing:30 ~ 80%Rh (Non condensation)

7-4. Structural Specifications

Installation Condition	Horizontal installation on the CS-20TRAD-specific table
Installation Space	65mm or more space is required on the front of the machine. 115mm or more space from handle is required on the rear. 50mm or more space is required on the right side when using Reject Cup. 20mm or more space is required on the right side when using Reject Chute.
External Dimension	227mm(W) X 380mm(D) X 165mm(H)
Weight	8.2Kg

8. External Dimensions/Installation Space

8-1. External Dimensions

Unit: mm[inch]

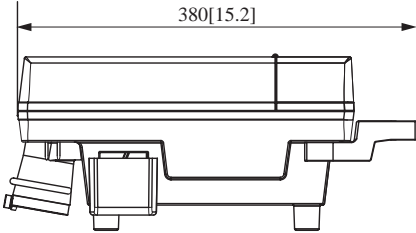

Right Side

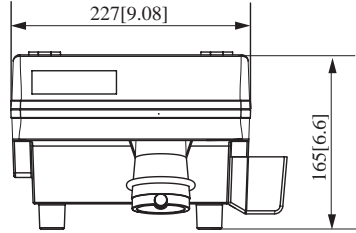

Front

8-2. Installation Space

Unit: mm [inch]

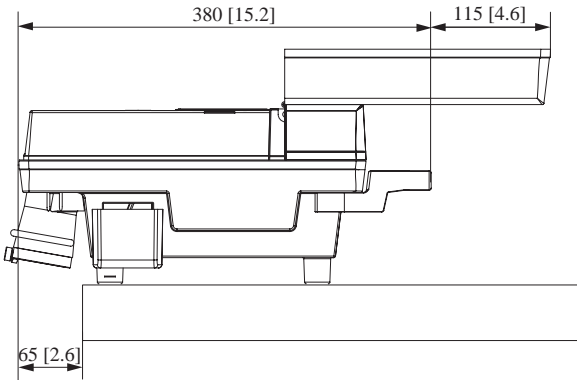

When the unit Cover is opened

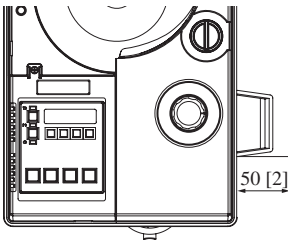

When using the Reject Cup

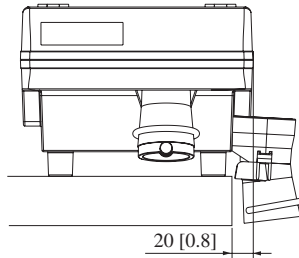

When using the Reject Chute

9. Installing/Removing Reject Cup (Chute)

The reject cup (chute) is attached by hooking it to the reject cup (chute) attachment opening on the right side of the unit and pressing it down. Please remove it by reversing this process.

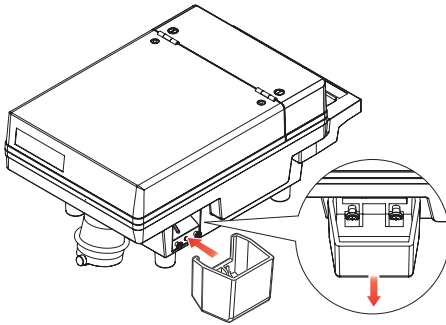

10. Operating Procedure

10-1. Adjustment of coin thickness/diameter

When adjusting coin thickness and diameter, Please operate it following the steps below.

1. Open the unit cover.

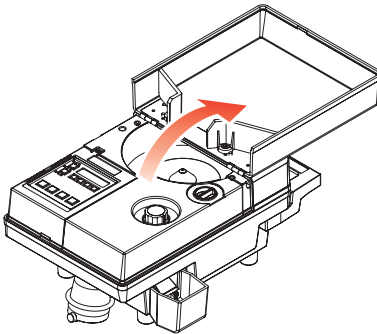

2. Set the coin guide.

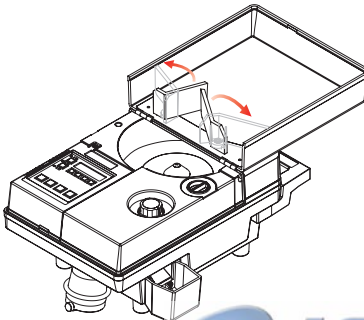

3. Remove the feed portion cover.

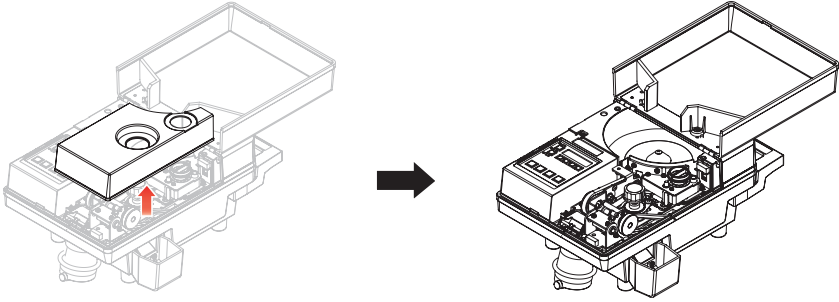

4. Raise the sorter belt assembly portion lever (described as “UP”).

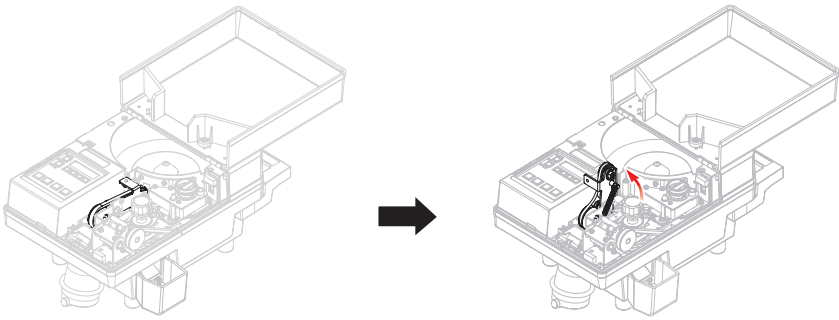

5. Place a coin under the hanger unit and turn the coin thickness adjustment dial to set the coin thickness. Adjust to the coin thickness with the dial and set it 1 pitch thicker.

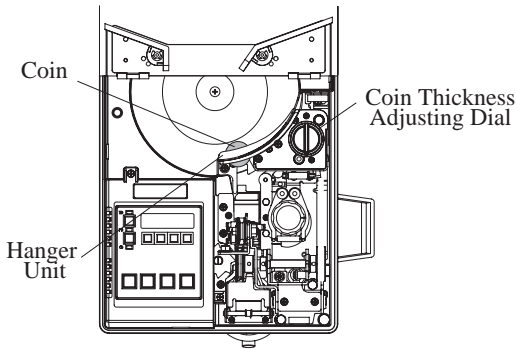

6. Turn the coin width adjustment dial to set the coin thickness. Adjust to the coin width with the dial and set it 1 pitch wider.

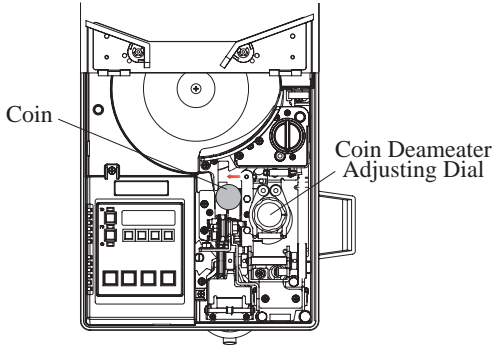

7. Return the sorter belt assembly portion to its original location and attach the feed portion cover.



- **When counting a variety of types of coins, set the coin width adjustment dial using the largest size coin.**

8. Plug the AC cord into the power socket and turn the ON the power button on the back of the unit.
9. Once “8888” has been displayed on the display screen, confirm that “0” is displayed.

10-2. Normal Mode

Follow the steps below to display the total of count of coins.

1. Insert the coin turntable portion.



- **Do not insert a large number of coins at one time.**
- **Please remove any damaged coins or foreign objects before starting counting.**

2. The counting begins when the Start Key [START] is pressed.
3. Press the Stop Key [STOP] once all of the coins have been counted.



- **The unit will automatically stop if no coins are counted with about 20 seconds after the Start Key [START] is pressed.**
- **Please check to see if there are any coins that were not selected in the reject cup after the counting has completed.**

10-3. Batch Mode

Follow the steps below to set the number of coins to be counted.

1. Please set the desired number (batch number) by pressing the Preset key while holding down the Batch Mode Key [S/B].

For example, if you want to set 300, press the Preset key intermittently while holding down the Batch mode Key [S/B] until the 3 is displayed in the 3rd digit.

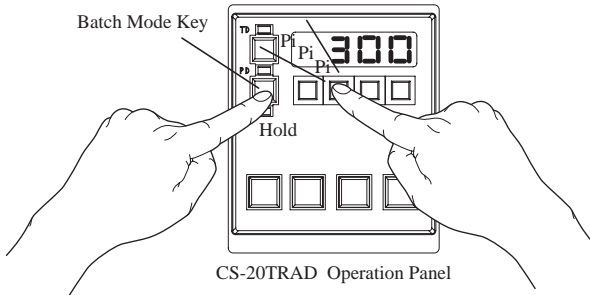

2. The CD lamp lights and counting begins when the Start Key [START] is pressed. It automatically stops when the batch number is reached.



- If the device stops before the batch number is reached, press the Start Key [START] to continue counting. Press the Clear Key [CLR] while holding the Batch Mode Key [S/B] to reset to start counting again from the beginning.

3. Press the Start Key [START] to continue batch counting.
4. Press the Continuous counting Mode Key [∞] when you want to know the total amount of the counted coins.

11. Coin JAM

The TD lamp or the CD lamp will light when the coins JAM occurs. Follow the steps below to clear the coin JAM.

1. Press the Reverse key [REV] to reverse the rotation of the turntable.

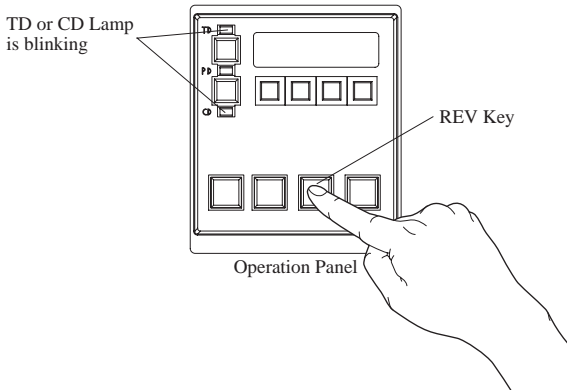

2. Remove the feed portion cover if the coin JAM is not cleared.

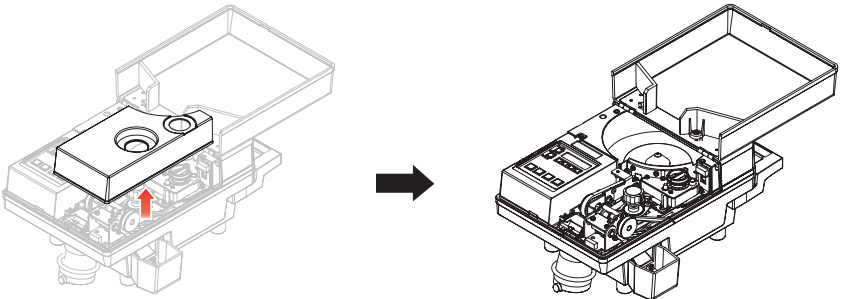

3. Raise the sorter belt assembly portion lever (discribed as "UP").

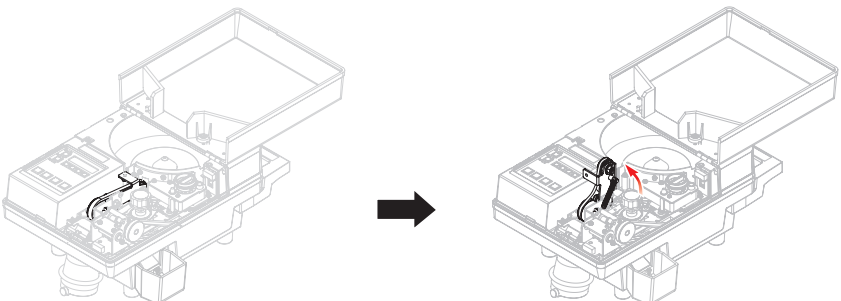

4. Slide the hanger lock fitting and raise the hanger unit.

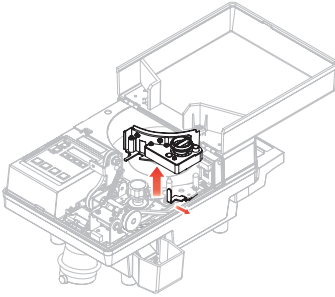

12. Error Detection

If an error has been detected, the lamp or display screen will be blinking.

Lamp Status	Error
TD lamp is blinking.	Coin JAM Error
PD lamp is blinking.	Batch Error
CD lamp is blinking.	Coin JAM Error
TD/PD/CD lamps and all segments of the display screen are blinking.	Blackout Detect Error
"7777" is displayed on the display screen and TD/PD/CD lamps are blinking.	Watchdog Monitoring Error

13. Cleaning

To maintain the performance of your CS-20TRAD, please check the following portion and clean them regularly.

Portion to be checked	Cleaning Method
Belts	Wipe the belts clean with cloth soaked with alcohol.
Hanger Unit Portion	Remove the hanger unit and wipe off or remove the soil or foreign objects.
Sorting Course Portion	Lift up the sorter belt assembly and wipe the course clean with a cloth soaked with alcohol.
Turntable Portion	Remove the soil or foreign objects and wipe the turntable with a soft cloth.

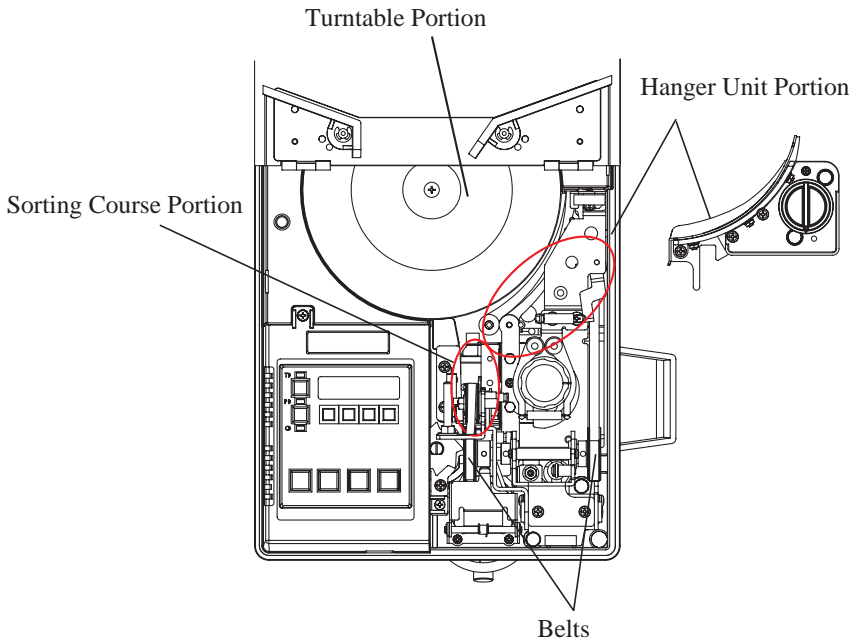

14. Replacing Fuse

If the inner board shorts and the fuse burns out due to abnormal voltage then power will not flow to the CS-20TRAD. Please follow the steps below to replace the fuse once the problem is resolved.



- **Confirm the specification and power voltage of your CS-20TRAD, only replace with a fuse with the same model name and the same rating**

1. Remove the power cord from the inlet.
2. Use a tool such as a flat blade screwdriver to open the fuse holder.

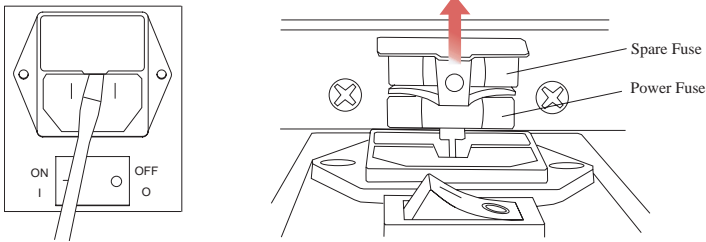

3. Remove the burned out fuse and slide out the spare fuse.

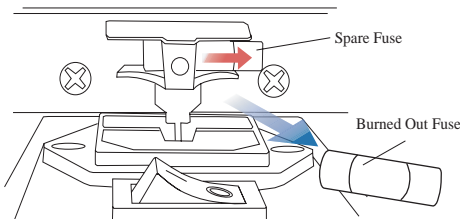

4. Insert the spare fuse in the place of the burned out fuse and press the fuse holder closed.

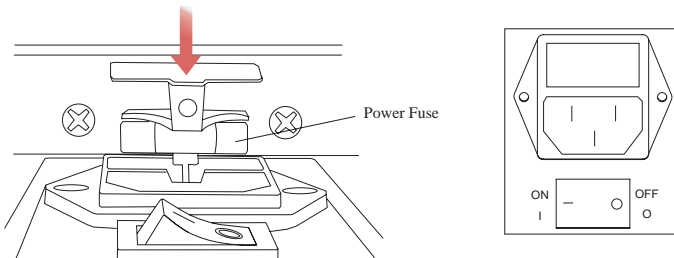

- **Confirm that the fuse has not popped out of the fuse holder. Do not force the fuse in if it has popped out. The fuse could become damaged.**

15. Product Support

If you happen to experience any problems or errors with your CS-20TRAD unit, or have any inquiries regarding your unit, consult with your nearest JCM contact as shown below. Please be sure to make a note of the problem points and symptoms, or the content of your inquiry, prior to making contact.

■ Japan

Japan Cash Machine Co., Ltd. (Headquarters)

No. 3-15, Nishiwaki 2-Chome,
Hirano-ku, Osaka 547-0035
Japan

Phone: +81-66-703-8406

Fax: +81-66-704-7843

URL: www.jcm-hq.co.jp

■ America, Oceania

JCM American Corporation

925 Pilot Road
Las Vegas, NV 89119
U.S.A.

Phone: +1-702-651-0000

Fax: +1-702-644-5512

e-mail: customerservice@jcm-american.com

URL: www.jcmamerican.com

■ Europe, Russia, Middle East, Africa

Japan Cash Machine Germany GmbH

Mündelheimer Weg 60
D-40472 Düsseldorf
Germany

Phone: +49-211-530645-60

Fax: +49-211-530645-85

e-mail: support@jcm-germany.com

URL: www.jcm-germany.com

■ UK, Ireland

JCM United Kingdom Ltd.

Unit B, Third Avenue,
Denbigh West Business Park
Bletchley, Milton Keynes,
Buckinghamshire MK1 1EJ,
UK

Phone: +44-870-770-2863

Fax: +44-190-837-7834

e-mail: info@jcm-uk.com

URL: www.jcm-uk.com

■ Asia (Other than Japan)

JCM Gold (HK) Ltd.

Unit 1-7, 3F, Favor Industrial Centre
2-6 Kin Hong Street, Kwai Chung, N.T.
Hong Kong

Phone: +852-2429-7187

Fax: +852-2929-7003

e-mail: cs@jcmgold.com.hk

URL: www.jcmgold.com.hk

NOTE

NOTE

Notice

Be aware that JCM shall not be held liable by the user for any damage, losses, or third party claims arising from the use of this products.

